

EVENT SPACE

Archer Napa's elegant event space is thoughtfully situated on the second floor — making it easy to access and navigate. Mix and match the event spaces for optimal fit and function.

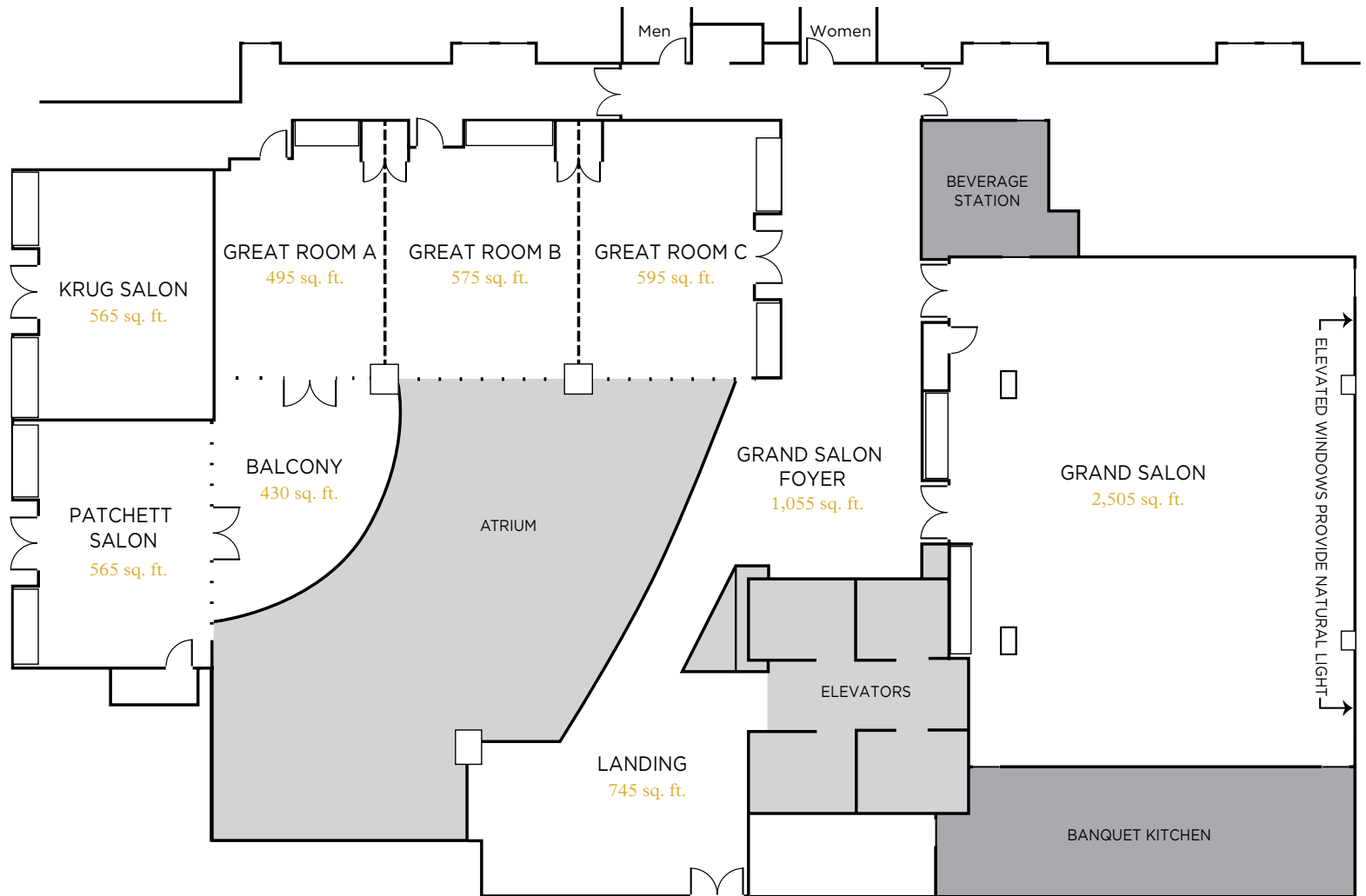

EVENT SPACE CAPACITIES

GRAND SALON

2,505 sq. ft.
56' x 45'
Banquet: 180
Classroom: 130
Crescent: 96
Hollow Square: 64
Reception: 180
Theatre: 200
U-Shape: 60

GRAND SALON FOYER

1,055 sq. ft.
Reception: 75

LANDING

745 sq. ft.
Reception: 50

GREAT ROOM

1,700 sq. ft.
28' x 60'
Banquet: 125
Classroom: 80
Crescent: 80
Hollow Square: 56
Reception: 159
Theatre: 180
U-Shape: 50

BALCONY

430 sq. ft.
26' x 20'
Banquet: 20
Reception: 25

GREAT ROOM A

495 sq. ft.
28' x 19'
Banquet: 36
Boardroom: 24
Classroom: 32
Crescent: 24
Hollow Square: 24
Reception: 40
Theatre: 50
U-Shape: 20

KRUG SALON

565 sq. ft.
27' x 19'
Banquet: 40
Boardroom: 24
Classroom: 40
Crescent: 30
Hollow Square: 24
Reception: 45
Theatre: 78
U-Shape: 20

GREAT ROOM B

575 sq. ft.
28' x 22'
Banquet: 40
Boardroom: 24
Classroom: 32
Crescent: 24
Hollow Square: 24
Reception: 45
Theatre: 60
U-Shape: 24

PATCHETT SALON

565 sq. ft.
28' x 19'
Banquet: 40
Boardroom: 26
Classroom: 40
Crescent: 30
Hollow Square: 24
Reception: 45
Theatre: 70
U-Shape: 22

GREAT ROOM C

595 sq. ft.
28' x 19'
Banquet: 36
Boardroom: 24
Classroom: 32
Crescent: 24
Hollow Square: 24
Reception: 45
Theatre: 52
U-Shape: 20

TOTAL

7,565 sq. ft.



#archerhotel



DOWNTOWN NAPA
1230 FIRST STREET, NAPA, CA 94559

LOCAL
707.690.9800

archerhotel.com

TOLL-FREE
855.437.9100

ROOFTOP

The Rooftop at Archer Napa is a destination unto its own, with sweeping valley views. The venue includes distinct areas that are easily reserved and combined for semi-private events, including a Chef's Show Kitchen. Whether posh receptions, winemaker's dinners or milestone celebrations, this starlit stage is sure to be Napa's new sought-after gathering spot.

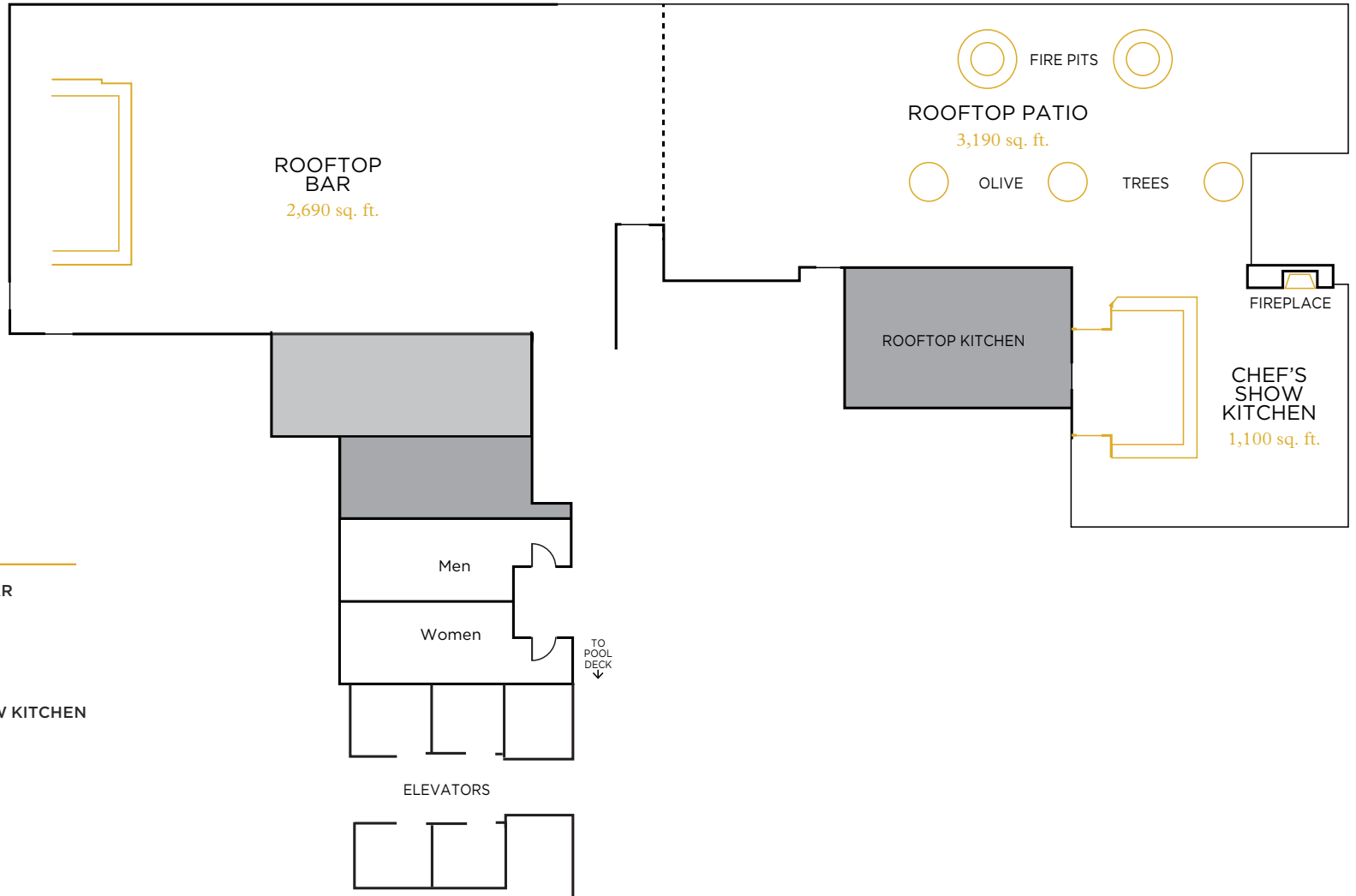

ROOFTOP CAPACITIES

ROOFTOP 6,980 sq. ft. 168' x 42' Seats: 168 Reception: 315	ROOFTOP BAR 2,690 sq. ft. 66' x 41' Seats: 80 Reception: 125
ROOFTOP PATIO 3,190 sq. ft. 105' x 30' Seats: 60 Reception: 150	CHEF'S SHOW KITCHEN 1,100 sq. ft. 33' x 35' Seats: 28 Reception: 40



ARCHER
HOTEL

DOWNTOWN NAPA
1230 FIRST STREET, NAPA, CA 94559

LOCAL
707.690.9800

archerhotel.com

TOLL-FREE
855.437.9100

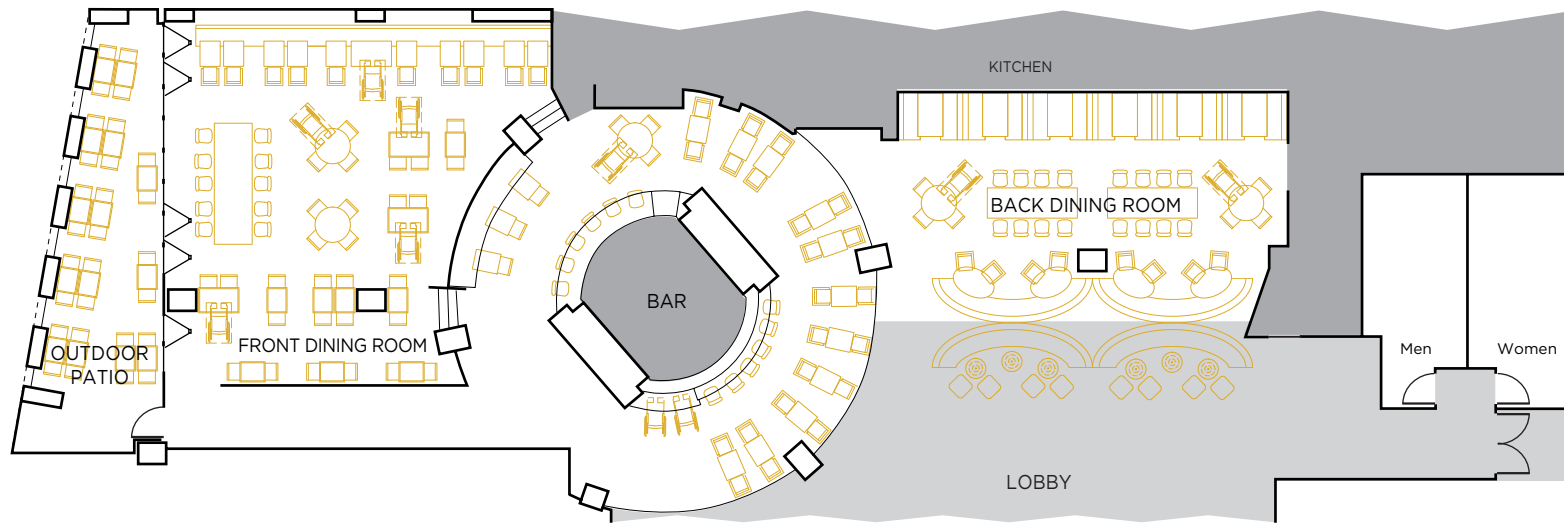

CHARLIE PALMER STEAK

Archer partners with Charlie Palmer Steak, highlighting the talents of executive chef Francisco Lopez Jr., who oversees all culinary for guests who choose to celebrate or meet at Archer Napa. The first floor restaurant, with its cozy banquettes and inviting communal tables, connects to Archer via a central lobby bar. The restaurant is an ideal venue for lunch or semiprivate evening events.

RESTAURANT CAPACITIES

FRONT DINING ROOM 1,362 sq. ft. Seats: 68	OUTDOOR PATIO 426 sq. ft. Seats: 28
BACK DINING ROOM 914 sq. ft. Seats: 68	BAR 1,350 sq. ft. Seats: 48



ARCHER
HOTEL

DOWNTOWN NAPA
1230 FIRST STREET, NAPA, CA 94559

LOCAL
707.690.9800

archerhotel.com

TOLL-FREE
855.437.9100