

EVENT SPACE

Archer Napa's elegant event space is thoughtfully situated on the second floor — making it easy to access and navigate. Mix and match the event spaces for optimal fit and function.

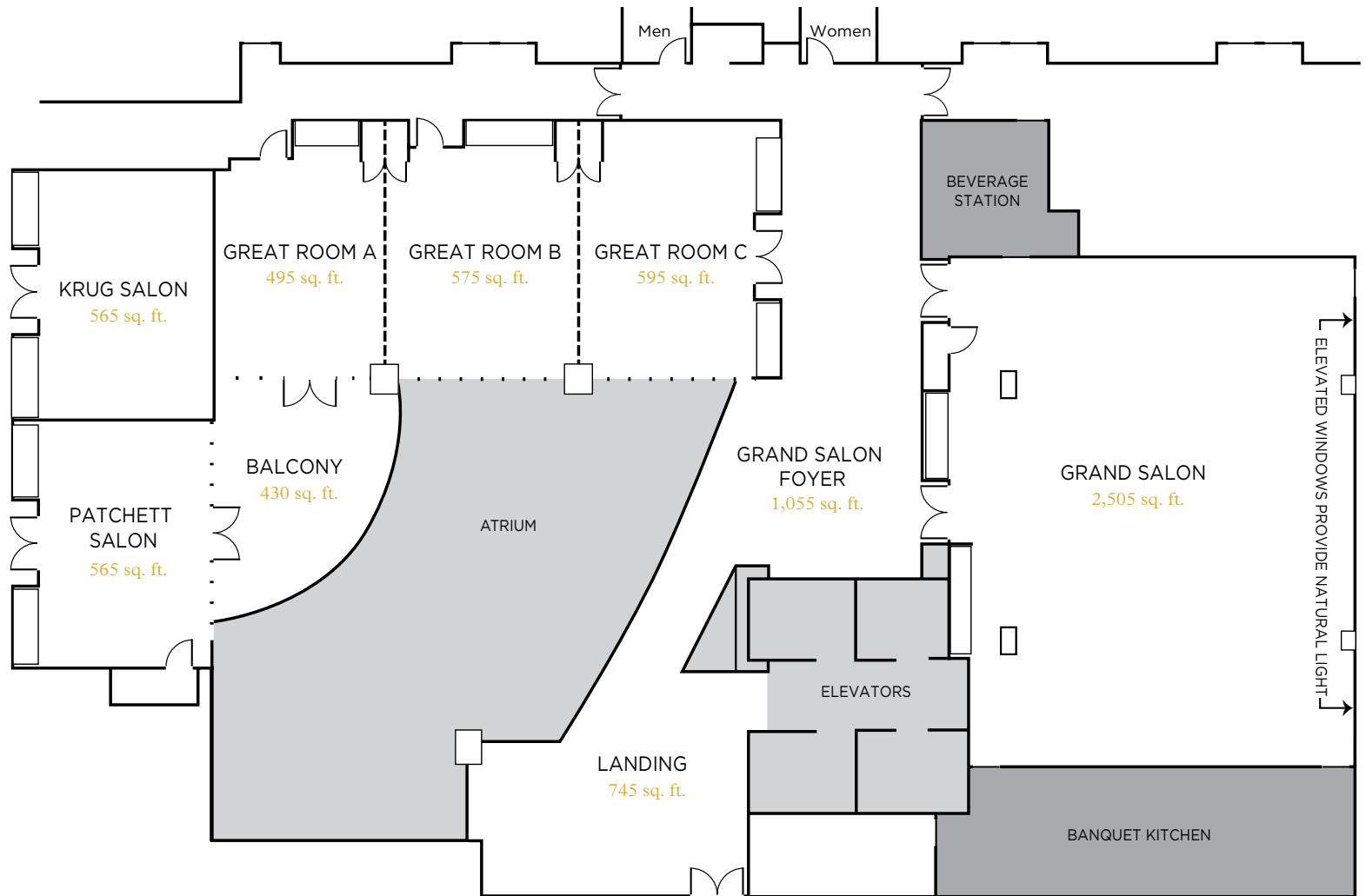

ARCHER
HOTEL

DOWNTOWN NAPA
1230 FIRST STREET, NAPA, CA 94559

LOCAL
707.690.9800

archerhotel.com

RESERVATIONS
855.200.9052

EVENT SPACE CAPACITIES — WITH SOCIAL SPACING

GRAND SALON

2,505 sq. ft.
56' x 45'
Crescent
(rounds of 6): 75
Conference: 60
U-Shape: 24

**GRAND SALON
FOYER**

1,055 sq. ft.
Reception: 80

LANDING

745 sq. ft.
Banquet: 14
Reception: 25

GREAT ROOM

1,700 sq. ft.
28' x 60'
Crescent
(rounds of 6): 32
Conference
(6 feet between chairs): 30
U-Shape
(6 feet between chairs): 20

GREAT ROOM A

495 sq. ft.
28' x 19'
Crescent
(rounds of 6): 18
Conference
(6 feet between chairs): 12
U-Shape
(6 feet between chairs): 10

GREAT ROOM B

575 sq. ft.
28' x 22'
Crescent
(rounds of 6): 18
Conference
(6 feet between chairs): 12
U-Shape
(6 feet between chairs): 10

GREAT ROOM C

595 sq. ft.
28' x 19'
Crescent
(rounds of 6): 18
Conference
(6 feet between chairs): 12
U-Shape
(6 feet between chairs): 10

KRUG SALON

565 sq. ft.
27' x 19'
Crescent
(rounds of 6): 18
U-Shape
(6 feet between chairs): 12
Conference
(6 feet between chairs): 12

PATCHETT SALON

565 sq. ft.
28' x 19'
Crescent
(rounds of 6): 18
Conference
(6 feet between chairs): 12
U-Shape
(6 feet between chairs): 12

BALCONY

430 sq. ft.
26' x 20'
Banquet: 18
Reception: 12

TOTAL
7,565 sq. ft.



#archerhotel

ROOFTOP

The Rooftop at Archer Napa is a destination unto its own, with sweeping valley views. The venue includes distinct areas that are easily reserved and combined for semi-private events, including a Chef's Show Kitchen. Whether posh receptions, winemaker's dinners or milestone celebrations, this starlit stage is sure to be Napa's new sought-after gathering spot.

ROOFTOP CAPACITIES — WITH SOCIAL SPACING

ROOFTOP BUYOUT 6,980 sq. ft. 168' x 42' Reception: 150	ROOFTOP BAR 2,690 sq. ft. 66' x 41' Seats: 36 Reception: 60
ROOFTOP PATIO 3,190 sq. ft. 105' x 30' Seats: 36 Reception: 100	CHEF'S SHOW KITCHEN 1,100 sq. ft. 33' x 35' Banquet: 18 Reception: 25
WATER DECK 550 sq. ft. 96' x 49' Reception: 38	

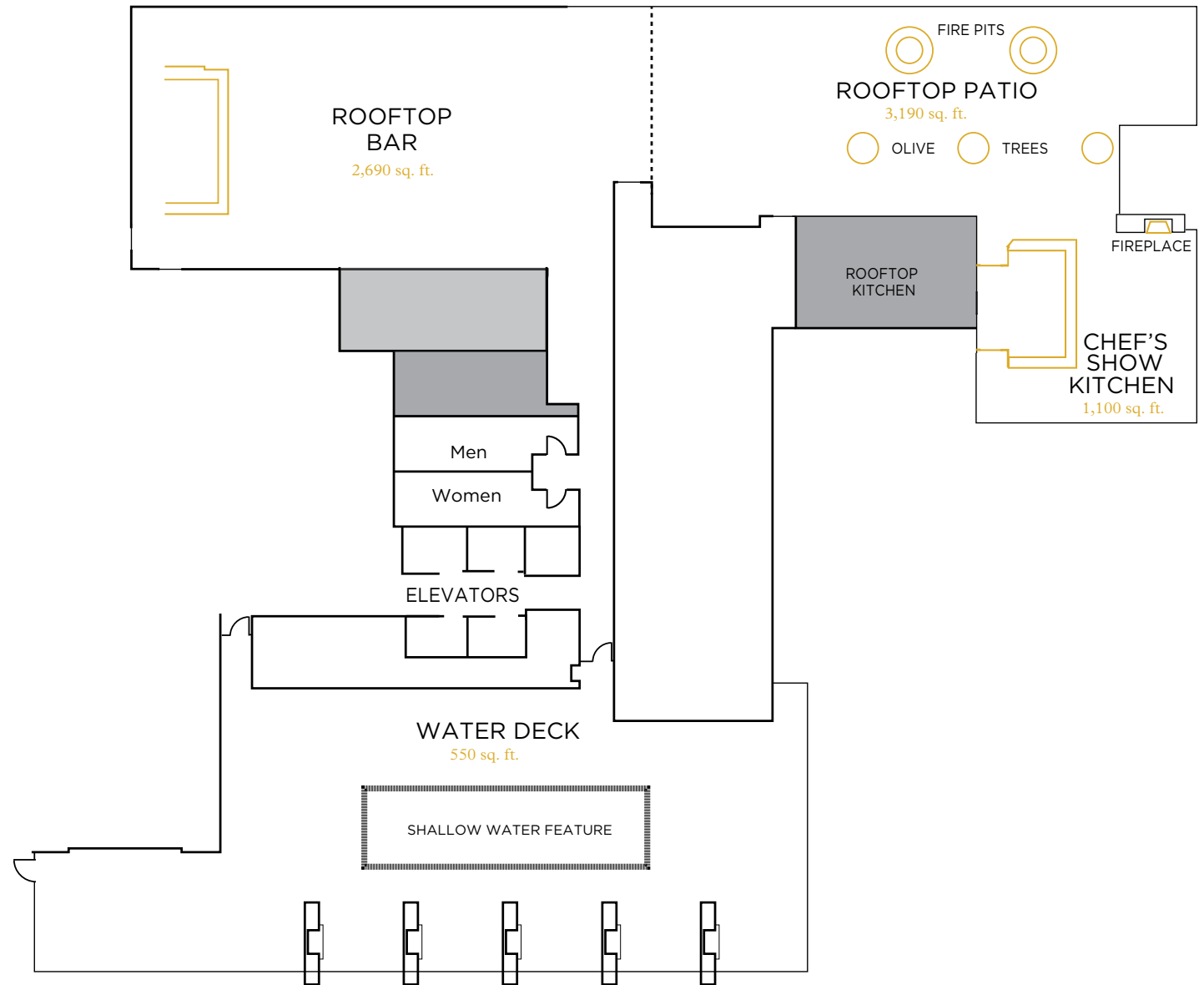

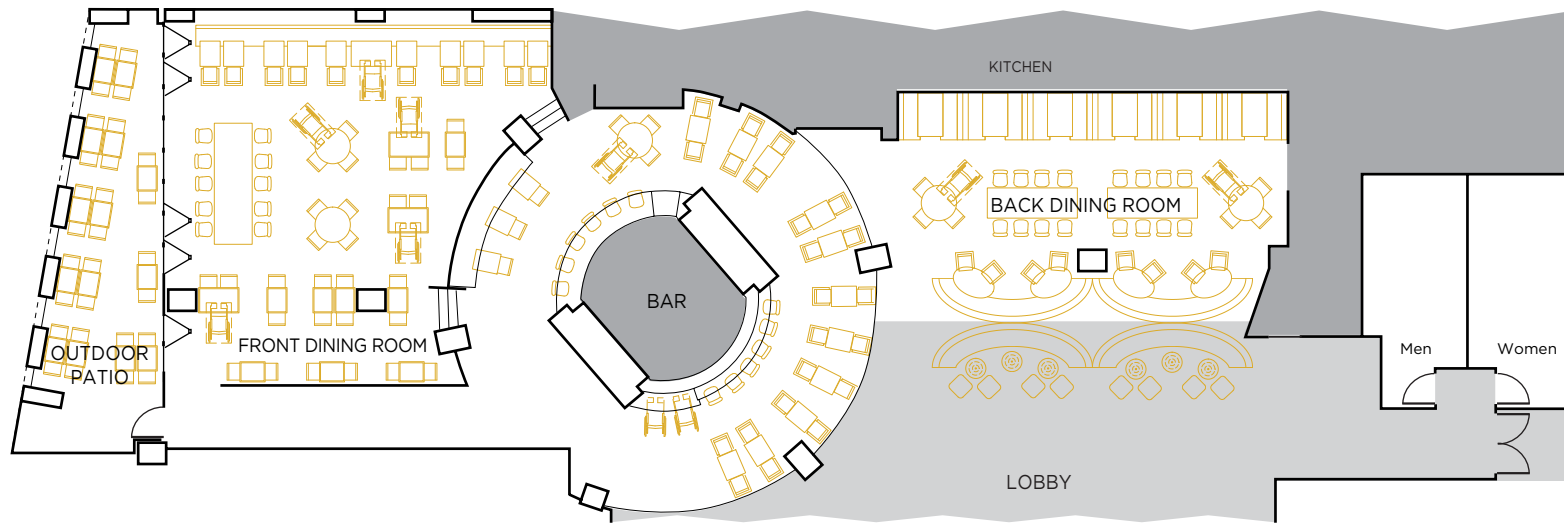

CHARLIE PALMER STEAK

Archer partners with Charlie Palmer Steak, highlighting the talents of executive chef Francisco Lopez Jr., who oversees all culinary for guests who choose to celebrate or meet at Archer Napa. The first-floor restaurant, with its cozy banquettes and inviting communal tables, connects to Archer via a central lobby bar. The restaurant is an ideal venue for lunch or semiprivate evening events.

RESTAURANT CAPACITIES — WITH SOCIAL SPACING

FRONT DINING ROOM 1,362 sq. ft. Seats: 34	OUTDOOR PATIO 426 sq. ft. Seats: 14
BACK DINING ROOM 914 sq. ft. Seats: 34	BAR 1,350 sq. ft. Seats: 24



ARCHER
HOTEL

DOWNTOWN NAPA
1230 FIRST STREET, NAPA, CA 94559

LOCAL
707.690.9800

archerhotel.com

RESERVATIONS
855.200.9052