

## EVENT SPACE

Archer Napa's elegant event space is thoughtfully situated on the second floor — making it easy to access and navigate. Mix and match the event spaces for optimal fit and function.

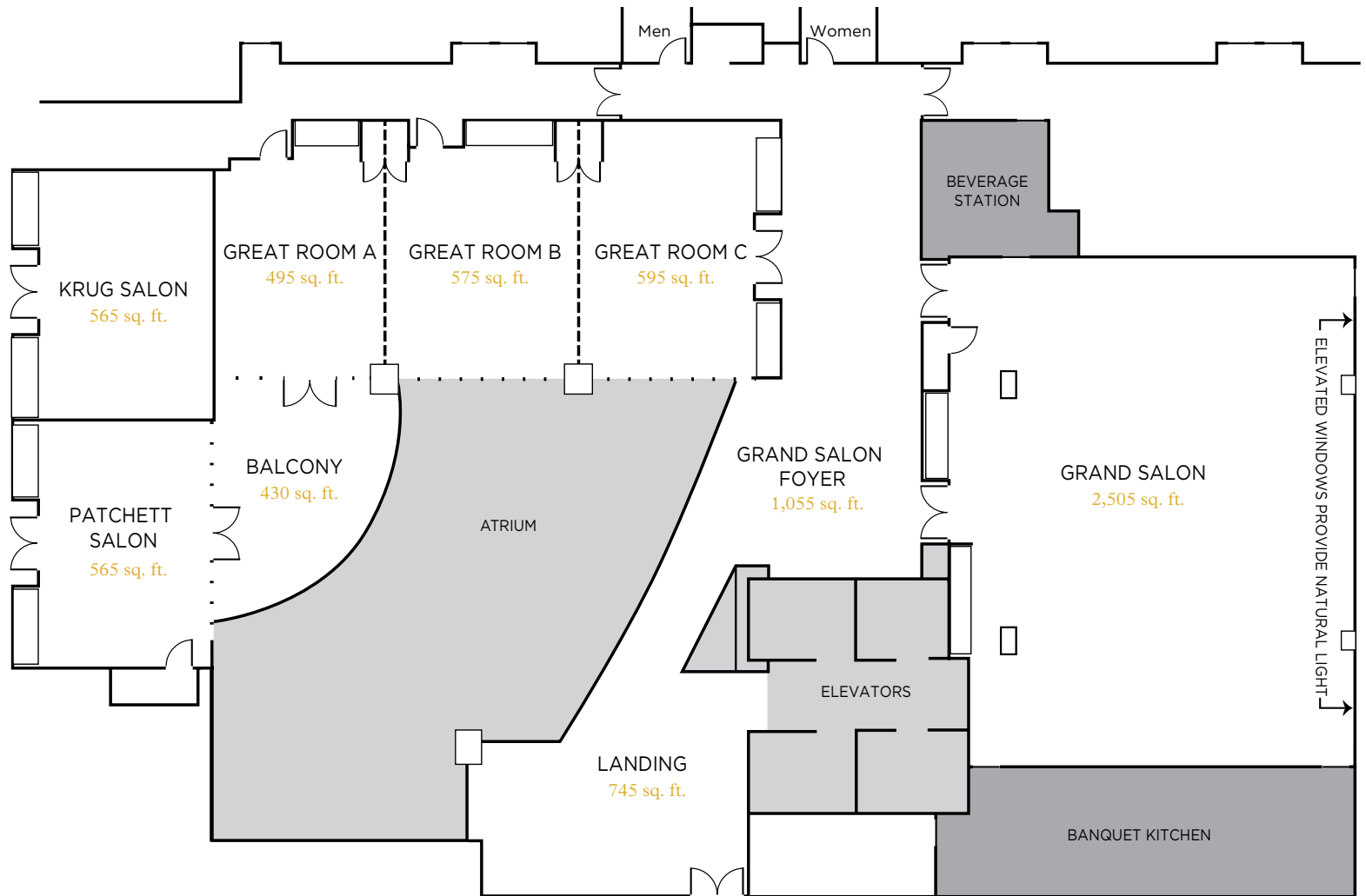

**ARCHER**  
HOTEL

**DOWNTOWN NAPA**  
1230 FIRST STREET, NAPA, CA 94559

**LOCAL**  
707.690.9800

*archerhotel.com*

**RESERVATIONS**  
855.200.9052

## EVENT SPACE CAPACITIES – STANDARD

<b>GRAND SALON</b> 2,505 sq. ft. 56' x 45' Banquet: 180 Classroom: 120 Crescent: 72 Hollow Square: 72 Reception: 180 Theatre: 200 U-Shape: 60 Double Conference: 100	<b>GREAT ROOM</b> 1,700 sq. ft. 28' x 60' Banquet: 90 Classroom: 64 Crescent: 64 Hollow Square: 72 Reception: 120 Theatre: 120 U-Shape: 42	<b>GREAT ROOM A</b> 495 sq. ft. 28' x 19' Banquet: 27 Conference: 20 Classroom: 24 Crescent: 21 Hollow Square: 24 Reception: 25 Theatre: 30 U-Shape: 20	<b>GREAT ROOM B</b> 575 sq. ft. 28' x 22' Banquet: 27 Conference: 20 Classroom: 24 Crescent: 21 Hollow Square: 24 Reception: 25 Theatre: 30 U-Shape: 20	<b>GREAT ROOM C</b> 595 sq. ft. 28' x 19' Banquet: 27 Conference: 20 Classroom: 24 Crescent: 21 Hollow Square: 24 Reception: 25 Theatre: 30 U-Shape: 20	<b>TOTAL</b> 7,565 sq. ft.
<b>GRAND SALON FOYER</b> 1,055 sq. ft. Reception: 80	<b>BALCONY</b> 430 sq. ft. 26' x 20' Banquet: 18 Reception: 25	<b>KRUG SALON</b> 565 sq. ft. 27' x 19' Banquet: 36 Conference: 20 Classroom: 32 Crescent: 32 Hollow Square: 24 Reception: 30 Theatre: 40 U-Shape: 20	<b>PATCHETT SALON</b> 565 sq. ft. 28' x 19' Banquet: 36 Conference: 20 Classroom: 32 Crescent: 32 Hollow Square: 24 Reception: 30 Theatre: 40 U-Shape: 20		
<b>LANDING</b> 745 sq. ft. Banquet: 27 Reception: 50					



#archerhotel



**DOWNTOWN NAPA**  
 1230 FIRST STREET, NAPA, CA 94559

**LOCAL**  
 707.690.9800

[archerhotel.com](http://archerhotel.com)

**RESERVATIONS**  
 855.200.9052

## ROOFTOP

The Rooftop at Archer Napa is a destination unto its own, with sweeping valley views. The venue includes distinct areas that are easily reserved and combined for semi-private events, including a Chef's Show Kitchen. Whether posh receptions, winemaker's dinners or milestone celebrations, this starlit stage is sure to be Napa's new sought-after gathering spot.

## ROOFTOP CAPACITIES

<b>ROOFTOP BUYOUT</b> 6,980 sq. ft. 168' x 42' Reception: 315	<b>ROOFTOP BAR</b> 2,690 sq. ft. 66' x 41' Seats: 80 Reception: 125
<b>ROOFTOP PATIO</b> 3,190 sq. ft. 105' x 30' Seats: 60 Reception: 200	<b>CHEF'S SHOW KITCHEN</b> 1,100 sq. ft. 33' x 35' Banquet: 32 Reception: 50
<b>WATER DECK</b> 550 sq. ft. 96' x 49' Reception: 70	

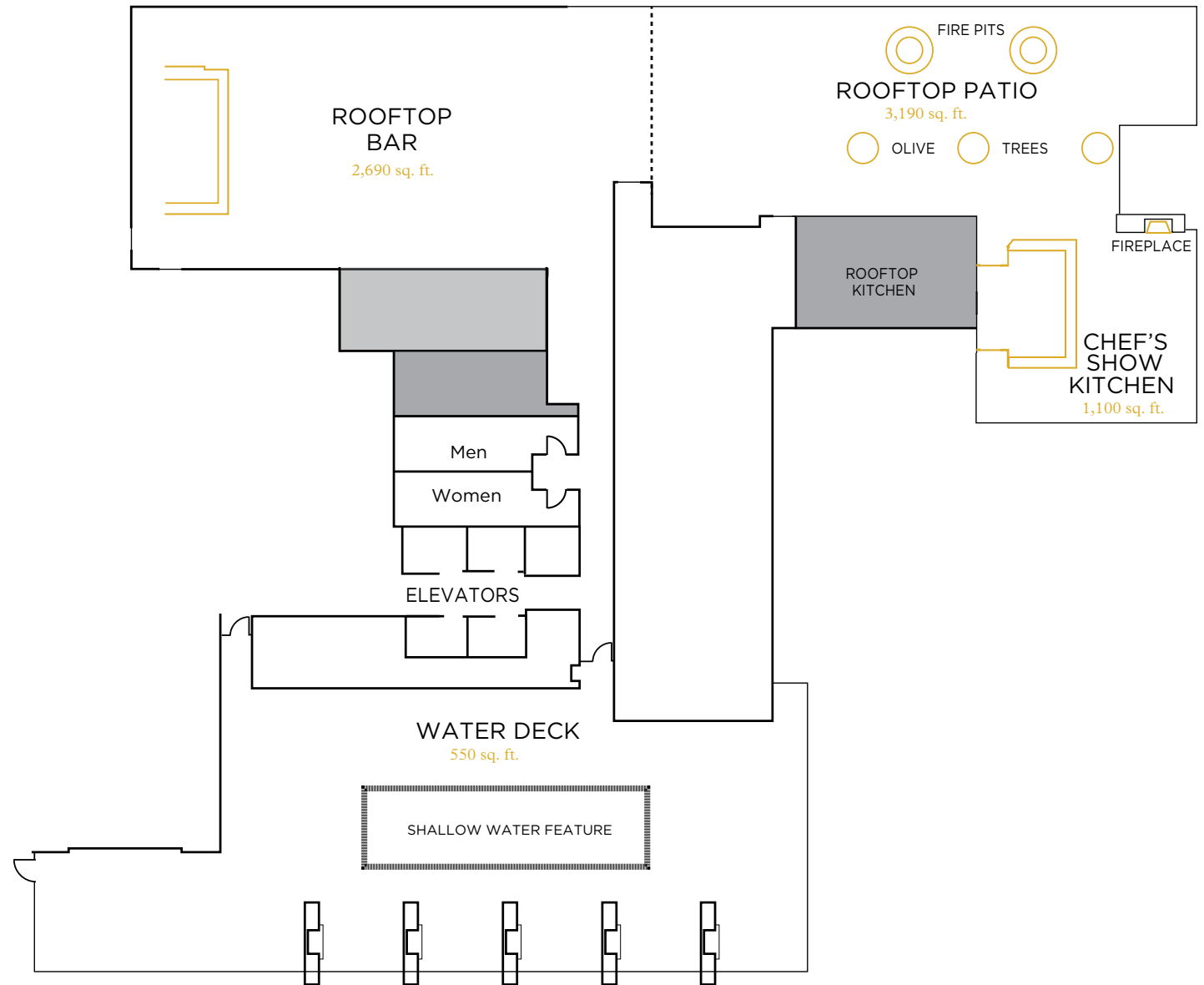

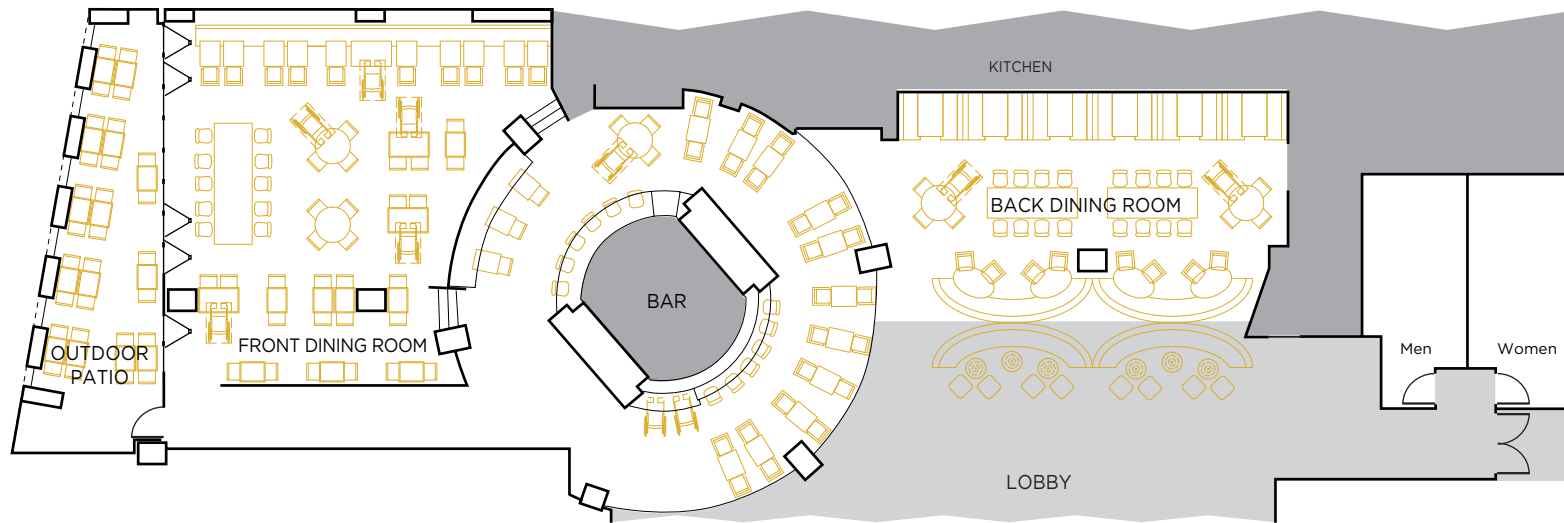

### CHARLIE PALMER STEAK

Archer partners with Charlie Palmer Steak, highlighting the talents of executive chef Francisco Lopez Jr., who oversees all culinary for guests who choose to celebrate or meet at Archer Napa. The first-floor restaurant, with its cozy banquettes and inviting communal tables, connects to Archer via a central lobby bar. The restaurant is an ideal venue for lunch or semiprivate evening events.

### RESTAURANT CAPACITIES

<b>FRONT DINING ROOM</b> 1,362 sq. ft. Seats: 68	<b>OUTDOOR PATIO</b> 426 sq. ft. Seats: 28
<b>BACK DINING ROOM</b> 914 sq. ft. Seats: 68	<b>BAR</b> 1,350 sq. ft. Seats: 48



**ARCHER**  
HOTEL

**DOWNTOWN NAPA**  
1230 FIRST STREET, NAPA, CA 94559

**LOCAL**  
707.690.9800

*archerhotel.com*

**RESERVATIONS**  
855.200.9052